

# Canon

imageRUNNER®  
C5800 / C6800



CORPORATE  
SYSTEMS



Color-enabled



## THE LEADER IN ADVANCED DIGITAL IMAGING EXPANDS ITS LEGACY.

The color-enabled imageRUNNER® C5800/C6800 are revolutionary digital multifunction solutions that are fast and versatile, and let you add color to your usual black-and-white work when you need it. They deliver high-speed, black-and-white output at 58/68 ppm and color output at 16 ppm, and easily can handle the workload of several dedicated devices.

Through their compact design, the imageRUNNER C5800/C6800 offer a complete suite of functionality, including advanced digital color copying and Mail Box features, color network printing and scanning functions, and the ability to distribute information across a dynamic landscape—all with the same industry-leading levels of performance, quality, and reliability you can expect only from Canon.

### imageRUNNER C5800/C6800 Specifications

Type:	Color Digital, Multifunction Imaging System	Optional:	3,500-sheet Paper Deck (Total: 7,700 Sheets)	<b>Automatic Document Feeder (Standard)</b>		
Imaging System:	Laser Dry Electrostatic Transfer	Multiple Copies:	1 to 9,999	Acceptable Originals:	Statement to 11" x 17"	
Developing System (B/W, Color):	Dry Monocomponent/Dual Component Toner Projection	Paper Weights:	17 lb. Bond to 110 lb. Index (Trays, Cassettes, Optional Paper Deck)	Capacity:	100 Sheets (Letter/20 lb.)	
Image Server Memory:	Standard 768MB RAM + 40GB HDD (Max. Capacity: Approximately 3,700 Originals)		17 lb. Bond to 140 lb. Index (Manual Bypass Tray)	Max. Paper Weights:	10 lb. to 32 lb. Bond (Simplex) 13 lb. to 32 lb. Bond (Duplex)	
First-copy Time:	5.3 Seconds (B/W) 12.2 Seconds (Color)	Dimensions (H x W x D):	46-7/8" x 26-3/4" x 33-1/2" (1191mm x 679mm x 852mm)	Original Scanning Speeds:	1-sided: 50 Sheets/Minute (Letter in B/W and Color); 70 Sheets/Minute @ 300 x 300 dpi (Letter in B/W and Color)**	
Warm-up Time:	9 Minutes or Less	Installation Space (W x D):	57-3/4" x 33-1/2" (1468mm x 852mm) (with Stack Bypass Extended)	Original Feeding Method:	From First Page (Top of Original)	
Copy Speed (B/W, Color):	58/68, 16 ppm (Letter) 34, 7.8 ppm (Legal) 28, 7.8 ppm (11" x 17") 25, 5.2 ppm (12" x 18") 42, 7.8 ppm (Letter-R) 58/68, 16 ppm (Statement-R)	Weight:	498 lb. (226kg)	Power Source:	From Main Unit	
Acceptable Originals:	Sheets, Books, 3-dimensional Items (Up to 4.4 lb.)	Power Requirements:	120V, 60Hz, 16A	Weight:	Approximately 32.4 lb. (14.7kg)	
Max. Original Size:	11" x 17"	Power Consumption:	1.75kW	<b>Finisher-R1/Saddle Finisher-R2</b>		
Max. Copy Size:	13" x 19"	Plug:	NEMA 5-20R	Number of Trays:	2 Trays	
Min. Copy Size:	4-1/8" x 5-7/8"	Drum:	Amorphous Silicon – Estimated Yield: 3,000,000 Impressions per Month	Tray Capacity		
Max. Mail Boxes Supported:	100	Maximum Duty Cycle:	230,000/280,000 Impressions per Month	Non-collate, Collate, and Group Mode:	1,000 Sheets (Letter, Statement-R, Executive) 500 Sheets (Legal, Letter-R, 11" x 17", 12" x 18", 13" x 19")	
Max. Copy Reservation:	5 Jobs	Toner		Staple Mode:	1,000 Sheets/30 Sets (Letter, Statement-R, Executive) 500 Sheets/30 Sets (Legal, Letter-R, 11" x 17")	
Copy/Scan Resolution:	600 x 600 dpi (256 Gradations) 8 Bit x 3 Colors	Black:	Magnetic Negative Toner (2kg) Estimated Yield: 40,000 Images (at 6% Coverage)	Max. Stapling Capacity		
Engine Resolution:	600 x 600 dpi (4 Bit, 16 Gradations)	Colors:	Non-magnetic Negative Toners (212g) Estimated Yield: 9,500 Images (at 5% Coverage)	Corner, Double:	50 Sheets (Letter), 30 Sheets (Letter-R, Legal, 11" x 17"; 17 lb. to 20 lb. Bond)	
Print Resolution:	2400 dpi x 600 dpi Interpolated	<b>Optional Accessories</b>			Acceptable Paper Weights:	17 lb. Bond to 140 lb. Index
Copy Exposure:	Automatic or Manual (9 Levels)	<b>Color Universal Send™ Kit-C1P*</b>			Saddle-stitching	
Original Type:	Text, Photo, Printed Image, Text/Photo/Map	Sending Methods:	E-mail, I-fax, Super G3 Fax (Additional Option), File Server, User Inbox (IPX, FTP, SMB)	Acceptable Paper Sizes:	Letter-R, Legal, 11" x 17"	
Halftones:	256 Gradations (Continuous-tone)	Address Book Capacity:	Max. 1,800 plus LDAP	Capacity/Tray:	1 to 5 Sheets/25 Sets 6 to 10 Sheets/15 Sets 11 to 15 Sheets/10 Sets	
Duplexing:	Standard Automatic Trayless Duplexing	File Format:	TIFF/PDF, PDF/PDF, PDF (Compact) TIFF/JPEG	Max. Stapling Capacity/Set:	15 Sheets	
Magnification:	25% to 400% (in 1% Increments) from Glass 25% to 200% (in 1% Increments) from Feeder	Sending Sizes:	Statement to 11" x 17"	Additional Finisher Tray-A1 (Optional):	100 Sheets†	
Preset Reduction/Enlargement:	25%, 50%, 64%, 73%, 78%, 121%, 129%, 200%, 400%	Resolutions:	100 x 100 dpi, 150 x 150 dpi 200 x 100 dpi, 200 x 200 dpi 200 x 400 dpi, 300 x 300 dpi 400 x 400 dpi, 600 x 600 dpi	Folding:	V-fold	
Paper Sources		Send System Environments:	Windows® 95/98/Me/XP, Windows NT® (SP6a), Windows 2000 Server/Professional (SP1 or Later), Windows Server 2003, Novell® NetWare® 3.2/4.1/4.11/4.2/5/5.1/6, Solaris™ Version 2.6 or Later, Mac OS X, Red Hat Linux 7.2	<b>Puncher Unit-M1††</b>		
Standard:	Dual Front-loading Trays (1,500 Sheets Each) Dual Front-loading Cassettes (550 Sheets Each) 100-sheet Stack Bypass			Max. Paper Weight:	Up to 140 lb. Index	
				Paper Sizes:	Letter, Legal, 11" x 17"	
				Punch Method:	Sequential Processing System (One Sheet at a Time)	
				Punch Types:	2-hole/3-hole (Auto Change) 3-hole (Letter/11" x 17") 2-hole (Legal/Letter-R)	
				Punch Dust Stock:	Approximately 3,000 Sheets	

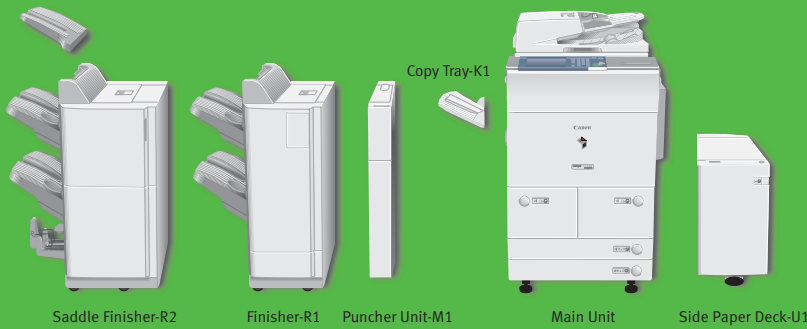

**imageRUNNER C5800/C6800 Specifications (Continued)**

Punch Dust Access: Front  
 Power Source: From Finisher-R1 or Saddle Finisher-R2  
 Dimensions (H x W x D): 32-3/4" x 4-1/4" x 24-1/4" (833mm x 107mm x 615mm)  
 Weight: Approximately 15.9 lb. (7.2kg)

**Side Paper Deck-U1**

Number of Drawers: 1  
 Paper Capacity: 3,500 Sheets (20 lb. Bond)  
 Paper Size: Letter  
 Paper Weight: 17 lb. Bond to 110 lb. Index  
 Power Source: From Main Unit  
 Dimensions (H x W x D): 22-5/8" x 12-7/8" x 23-3/8" (574mm x 326mm x 583mm)  
 Weight: Approximately 101 lb. (46kg)

**Canon Color Network Multi-PDL Printer Kit-C1**

Processor: Canon Custom Processor—Shared  
 RAM: 768MB (Std./Max.)—Shared  
 Hard Disk: 40GB—Shared  
 PDL Support: PCL 5c, PostScript® 3™ Emulation, UFR

**Interface Connections**

Standard: RJ-45 (10/100Base-T)  
 Optional: Token Ring, USB Full-speed (1.1 Equivalent)

Internal Fonts: PS: 136 Fonts  
 PCL 5c: 80 Roman, 1 Bitmap, 32 Bar Code

Protocol Stacks: NetWare: Autosense 802.2, 802.3, Ethernet II, 802.2 SNAP (Phase II Only)  
 AppleTalk®: 802.2 SNAP (Phase II Only)

Network OS: Windows 98/Me/2000/XP, Windows NT 4.0, Solaris 1.x, 2.5, or later, Apple® System 7.5 or higher, Novell NetWare v.3.2, 4.1, 4.11, 4.2, 5, 5.1, 6

Print Service: NetWare: NDS Pserver, Bindery Pserver, Nprinter, Rprinter  
 TCP/IP: LPD/LPR, RAW (Port 9100), IPP 1.1, SMB, FTP  
 AppleTalk: PAP (PostScript)

Utilities and Software: NetSpot® Console, NetSpot Job Monitor  
 Remote UI™  
 Color Network ScanGear  
 NetSpot Resource Downloader  
 NetSpot Device Installer  
 Canon LPR  
 Canon NDPS GW

**imagePASS-D1**

Type: Intel® Pentium® III External Piggy-back Controller  
 Processor: 850MHz Processor  
 RAM: 128MB (Std.), 256MB (Max.)  
 Hard Disk: 20GB  
 PDL Support: Adobe PostScript 3, PCL 5c

**Interface Connections**

Standard: RJ-45 (10/100Base-T)  
 Parallel Port (Type B Connector)

Internal Fonts: PS: 136 Fonts (117 Adobe® Type and 19 TrueType®)

Protocol Stacks: PCL 5c: 113 Roman  
 Ethernet  
 IPX/SPX™: 802.2, 802.3, Ethernet II, Ethernet SNAP  
 TCP/IP: Ethernet II  
 AppleTalk: Ethernet SNAP

Network OS: Novell NetWare v.4.1/4.2/5/5.1/6.0 (IPX/SPX)  
 Windows 98/Me/2000/XP, Windows NT (TCP/IP), Solaris 2.5.1 or later, Apple System 7.5 or higher (DDP)

Dimensions (H x W x D): 13-1/8" x 11-3/8" x 2-7/8" (334mm x 290mm x 72mm)

Weight: 7.5 lb. (3.4kg)  
 Power Requirements: 100 to 240V, 50/60Hz, 2A 35W  
 Power Consumption: NetSpot Console  
 Utilities and Software: Remote UI, Color Network ScanGear, EMS Open View, EMS NetView, EMS Unicenter TNG

Additional Functions: Remote UI, Color Network ScanGear, EMS Open View, EMS NetView, EMS Unicenter TNG

Fiery® Tools: WebTools™, Command WorkStation®, Fiery Downloader™, Fiery Remote Scan, ColorWise® Pro Tools (Calibrator, Color Editor, Profile Manager, Color Setup, Spot-On®), Device Status Extension, NetSpot Device Installer, Canon LPR, Canon NDPS GW, Canon Font Manager 2000  
 Optional: EFI Densitometer ED-100

**Other Optional Accessories and Utilities**

- Accessibility Handle-A1
- Braille Label Kit-A1
- Card Reader-C1
- Card Reader Attachment-C1
- Card Sets
- Cassette-AA1
- Control Card IV
- Control Card Printer-A1
- Copy Tray-K1
- Document Tray-K1†††
- eCopy Suite
- imageRUNNER Security Kit-A1P
- imageWARE Suite
- Key Switch Unit-A2
- NetSpot Suite
- Resolution Switching Board-A2
- Stamp Ink Cartridge-B1
- Super G3 Fax Board-P1\*
- Token Ring Network I/F Adaptor IN-TR2
- USB Interface Board-A3

\* Requires Resolution Switching Board-A2.

\*\* 70 ipm @ 300 x 300 dpi available only for Send and Scan modes.

† Use of Additional Finisher Tray-A1 will alter top tray capacity when outputting Letter/Statement-R/ Executive documents.

†† Puncher Unit-M1 can only be installed with either the Finisher-R1 or Saddle Finisher-R2.

††† Standard on the imageRUNNER C6800. Optional on the imageRUNNER C5800.

© 2004 Canon U.S.A., Inc. All rights reserved.

As an ENERGY STAR® Partner, Canon U.S.A., Inc. has determined that this product meets the ENERGY STAR® guidelines for energy efficiency. ENERGY STAR and the ENERGY STAR certification mark are registered U.S. marks. Windows and Windows NT are registered trademarks of Microsoft Corporation in the United States and/or other countries. Adobe and PostScript are registered trademarks of Adobe Systems Incorporated in the United States and/or other countries. Apple, AppleTalk, and TrueType are registered trademarks of Apple Computer, Inc. Intel and Pentium are registered trademarks of Intel Corporation. Novell and NetWare are registered trademarks of Novell, Inc. in the United States and other countries. IPX/SPX is a trademark of Novell, Inc. NetView is a registered trademark of IBM in the United States. Solaris is a trademark of Sun Microsystems, Inc. in the United States and other countries. Unicenter is a registered trademark of Computer Associates International, Inc. EFI, ColorWise, Command WorkStation, Spot-On, and Fiery are registered trademarks of Electronics for Imaging, Inc. in the U.S. Patent and Trademark Office and certain other foreign jurisdictions. Fiery Downloader and WebTools are trademarks of Electronics for Imaging, Inc. Canon, IMAGERUNNER, NetSpot, and Canon Know How are registered trademarks, and Universal Send and the GENUINE logo are trademarks of Canon Inc. in the United States and may also be registered trademarks or trademarks in other countries. IMAGEWARE and Remote UI are trademarks of Canon U.S.A., Inc. IMAGEANYWARE is a registered service mark of Canon U.S.A., Inc. in the United States. All other terms and product names may be trademarks or registered trademarks of their respective owners and are hereby acknowledged.

Federal Law prohibits copying of certain documents. Violators may be subject to penalties. We suggest that you check with you own legal counsel. Canon U.S.A., Inc. and Canon Canada intend to cooperate with Law Enforcement Agencies in connection with claims of unauthorized copying.

Specifications subject to change without notice.

**Canon** KNOW HOW®

1-800-OK-CANON  
[www.usa.canon.com](http://www.usa.canon.com)

Canon U.S.A., Inc.  
One Canon Plaza  
Lake Success, NY 11042

0904-C5800/C6800-PDF

