

Samsung Printer SMART MultiXpress X3280 Series

General	
Processor	1 GHz (Dual Core)
Operational Panel	7" Color Touch-Panel LCD, 800 x 480 (WVGA)
Memory	2 GB
Hard Disk Drive	320 GB or higher User Available Space: 300 GB
Interface (Standard)	High Speed USB 2.0 Device/Host, Ethernet 10/100/1000 BASE TX
Interface (Optional)	IEEE 802.11 b/g/n + NFC Active Type
Power Consumption	Max 1.75 kW (Ready: 60 Wh, Sleep: 1.5 W)
Dimension (WxDxH)	566 x 620 x 870 mm (22.3" x 24.4" x 34.3")
Max Dimension (WxDxH)	566 x 620 x 1,130 mm (22.3" x 24.4" x 44.5")
Weight	82.3 kg (181.44 lb)
Max. Monthly Duty Cycle	X3220NR: 60,000 Pages X3280NR: 80,000 Pages
Network Security	SSL/TLS, IPsec, SNMPv3, Protocol & Port Management, IPv6, IP/MAC Filtering, IEEE 802.1x

Print	
Speed (Mono / Color)	X3220NR: 22 / 22 ppm in A4/Letter X3280NR: 28 / 28 ppm in A4/Letter
Resolution	Default: 2,400 x 600 dpi Effective Output (600 x 600 x 2 bit) / Max: 9,600 x 600 dpi Effective Output (600 x 600 x 4 bit), 1,200 x 1,200 dpi (Half Speed)
Print Languages	PCL5e, PCL6, PostScript3, PDF V1.7
Client OS Support	Windows: Windows XP (32/64 bit), Vista (32/64 bit), 2003 Server (32/64 bit), 2008 Server (32/64 bit), Win7 (32/64 bit), 2008 Server R2 (64 bit), Win8 (32/64 bit), Win8.1 (32/64 bit), 2012 Server (64 bit), 2012 Server R2 (64 bit) / Mac OS 10.6-10.10 / Linux: Red Hat Enterprise Linux 5, 6, 7 / Fedora 13, 14, 15, 16, 17, 18, 19, 20, 21 / openSUSE 11.3, 11.4, 12.1, 12.2, 12.3, 13.1, 13.2 / Ubuntu 10.04, 10.10, 11.04, 11.10, 12.04, 12.10, 13.04, 13.10, 14.04, 14.10 / SUSE Linux Enterprise Desktop 11, 12 / Debian 6, 7 / Mint 13, 14, 15, 16, 17 / Unix: Sun Solaris 9, 10, 11 (x86, SPARC) / HP-UX 11.0, 11i v1, 11i v2, 11i v3 (PA-RISC, Itanium) / IBM AIX 5.1, 5.2, 5.3, 5.4, 6.1, 7.1 (PowerPC)
Network Protocols	IP Management (DHCP, BOOTP, AutoIP, SetIP, Static) / Discovery Protocol (SLP, UPnP, Bonjour, DNS, WINS) / Printing Protocol (TCP/IP, LPR, IPP, WSD) / Management Protocol (SNMPv1.2, SNMP3, POP3, SMTP, Telnet) / Scan Protocol (SMTP, FTP, SMB, WSD) / Security Protocol (SMB, Kerberos, LDAP, IPsec, EAP)

Scan	
Speed (Mono / Color)	45 / 45 ipm (300 dpi / A4/Letter)
Compatibility	Network TWAIN
Resolution (Optical)	600 x 600 dpi
Resolution (Enhanced)	Up to 4,800 x 4,800 dpi
Scan Destinations	Email, FTP, SMB, HDD, DFS, USB, WSD, PC

Copy	
Speed (Mono / Color)	X3220NR: 22 / 22 ppm in A4/Letter X3280NR: 28 / 28 ppm in A4/Letter
First Copy Out Time (Mono / Color)	X3220NR: 7.2 / 9.0 seconds X3280NR: 6.2 / 7.6 seconds
Resolution	600 x 600 dpi
Reduce / Enlarge Range	25% - 400%
Multi Copy	9,999 Pages
Copy Features	ID Copy / N-up / Booklet / Image Repeat / Auto Fit / Book Copy / Poster Copy / Watermark / Image Overlay / Stamp / Covers / Job Build / Preview / Erase Edge / Image Shift / Image Adjustment / Background Adjustment

Fax	
Compatibility	ITU-T G3, Super G3
Modem Speed	33.6 kbps
Resolution	Up to 600 x 600 dpi (Mono)
Features	Speed Dial / Group Dial / On-hook Dial / Auto Redial / Caller ID / Secure Reception / Fax forwarding, etc.

Paper Handling	
Input Capacity (Cassette)	1,040 Sheets
Input Capacity (Maximum)	2,180 Sheets (1,140-Sheet Standard + 1,040-Sheet Optional DCF)
Input Capacity (Multipurpose Tray)	100 Sheets
Input Capacity (Other Options)	520-Sheet Optional Cassette x 2
Media Type (Cassette)	Plain Paper / Thin Paper / Bond / Punched / Pre-Printed / Recycled / Label / CardStock / Letterhead / Thick / Cotton / Colored / Archive / Thin Glossy / Heavy Weight/ Extra Heavy Weight
Media Type (Multipurpose Tray)	Plain / Thin / Bond / Hole Punched / Pre-Printed / Recycled / Label / Thin CardStock / Letterhead / Thick / Cotton / Colored / Archive / Thin Glossy / Heavy Weight / Envelope

Media Type (Other Options)	Plain Paper / Thin Paper / Bond / Punched / Pre-Printed / Recycled / Label / CardStock / Letterhead / Thick / Cotton / Colored / Archive / Thin Glossy / Heavy Weight/ Extra Heavy Weight
Media Size (Cassette)	Cassette 1: 148 x 210 mm-297 x 354 mm (5.8" x 8.2"-11.7" x 14") / Cassette 2: 148 x 210 mm-297 x 432 mm (5.8" x 8.2"-11.7" x 17")
Media Size (Multipurpose Tray)	98 x 148 mm-297 x 432 mm (3.8" x 5.8" -11.7" x 17")
Media Size (Other Options)	148 x 210 mm-297 x 432 mm (5.8" x 8.2" -11.7" x 17")
Media Weights (Cassette)	Plain Paper: 70-90 g/m2 (18.5-24 lb/Dupl) / Thick Paper: 91-105 g/m2 (25-28 lb/Dupl) / Heavy Weight Paper: 106-176g/m2 (Dupl) / Extra Heavy Weight 1 Paper: 177-220 g/m2 / Thin Paper: 60-69 g/m2 (16-19 lb/Dupl) / Cotton paper: 75-90 g/m2 (Dupl) / Colored: 75-90 g/m2 (Dupl) / Pre-Printed: 75-90 g/m2 (Dupl) / Recycled: 60-90 g/m2 (Dupl) / Bond Paper: 105-120 g/m2 (Dupl) / Letterhead: 75-90 g/m2 (Dupl) / Hole Punched Paper: 75-90 g/m2 (Dupl) / Thin CardStock: 106-163 g/m2 (Dupl) / Thin Glossy: 106-163 g/m2 (Duplex)
Media Weights (Multipurpose Tray)	16-47 lb (60 to 176 g/m2); Simplex, Duplex / Envelope (75-90 g/m2) / Label (120-150 g/m2); Simplex
Media Weights (Other Options)	Plain Paper: 70-90 g/m2 (18.5-24 lb/Dupl) / Thick Paper: 91-105 g/m2 (25-28 lb/Dupl) / Heavy Weight Paper: 106-176 g/m2 (Dupl) / Extra Heavy Weight 1 Paper: 177-220 g/m2 / Thin Paper: 60-69 g/m2 (16-19 lb/Dupl) / Cotton paper: 75-90 g/m2 (Dupl) / Colored: 75-90 g/m2 (Dupl) / Pre-Printed: 75-90 g/m2 (Dupl) / Recycled: 60-90 g/m2 (Dupl) / Bond Paper: 105-120 g/m2 (Dupl) / Letterhead: 75-90 g/m2 (Dupl) / Hole Punched Paper: 75-90 g/m2 (Dupl) / Thin CardStock: 106-163 g/m2 (Dupl) / Thin Glossy: 106-163 g/m2 (Duplex)

Options	
Inner Finisher (SL-FIN501L)	
Job Separator (SL-JSP500S)	
Cabinet Stand, Dual Cassette Feeder	
Fax Kit, FDI Kit, Wireless/NFC Kit	
* Inner Finisher is only available for X3280NR.	

Supplies	
Toner (Black / Color)	20,000 / 15,000 pages (5% Coverage)
Imaging Unit/Drum (Black / Color)	50,000 / 50,000 pages
Waste Toner Container	Approx. 33,700 pages (5% Coverage)

Samsung Multifunction

SMART MultiXpress X3280 Series

Performance and savings you need
Reliability you can trust



BACKGROUND

The A3 color printer market is maintaining strong performance, primarily in the number of units sold in the 21 - 30 ppm segment. As main vertical markets in this segment, education, insurance and retail SMBs require smart printers that can keep pace with the speed of business. These SMBs require easy-to-use, cost-effective printers with fast, high-quality printing and scanning to maintain their competitive edge. Quick diagnostics and servicing are also critical to ensure low total cost of ownership (TCO), easy troubleshooting and better business agility.

SAMSUNG
BUSINESS

About Samsung Electronics Co., Ltd.

Samsung Electronics Co., Ltd. inspires the world and shapes the future with transformative ideas and technologies, redefining the worlds of TVs, smartphones, wearable devices, tablets, cameras, digital appliances, printers, medical equipment, network systems and semiconductors. We are also leading in the Internet of Things space through, among others, our Digital Health and Smart Home initiatives. We employ 307,000 people across 84 countries. To discover more, please visit our official website at www.samsung.com and our official blog at global.samsungtomorrow.com.

Copyright © 2015 Samsung Electronics Co., Ltd. All rights reserved. Samsung and Samsung Cloud Print are either trademarks or registered trademarks of Samsung Electronics Co., Ltd. Specifications and designs are subject to change without notice. Nonmetric weights and measurements are approximate. All data were deemed correct at time of creation. Samsung is not liable for errors or omissions. All brand, product, service names and logos are trademarks and/or registered trademarks of their respective owners and are hereby recognized and acknowledged.

AirPrint is a trademark of Apple Inc. registered in the U.S. and other countries. Android and Google Cloud Print are trademarks of Google Inc. Samsung Cloud Print is either a trademark or registered trademark of Samsung Electronics Co., Ltd. Microsoft and Windows are registered trademarks of Microsoft Corporation in the United States and/or other countries.

Samsung Electronics Co., Ltd.

129 Samsung-ro, Yeongtong-gu, Suwon-si, Gyeonggi-do 443-742, Korea

2015-10



SMARTIFY
YOUR BUSINESS.
PRINTING INNOVATION.

SAMSUNG
BUSINESS

OVERVIEW

Samsung's X3280 Series A3 color multifunction printer (MFP) delivers exceptional business performance, reliability and savings for SMBs. Its fast 1 GHz dual core processor, high scan speed and superior graphic quality keep you business ready. And its 7" capacitive touchscreen (TSP) and Active NFC make printing smarter and easier, both in the office and on the go. It also features robust security and industry-leading monthly duty cycle for top-notch reliability, plus the performance of Samsung MultiXpress X4300 Series but at a lower cost.

For dealers, X3280 Series offers an ideal business model. NFC Pro helps you effectively support your customers' business mobility performance and Bring Your Own Device (BYOD) needs with anywhere mobile printing. You can also quickly respond to your customers' service requests using the Samsung Smart Printer Diagnostic System (SPDS) application to maintain reliable print operations. Most importantly, X3280 Series shares service parts with MX4 to help lower your management and maintenance costs.

KEY BENEFITS



Print faster with high quality

Samsung X3280 series offers faster and high quality printing:

- 1 GHz dual-core processor, 2 GB of memory and fast scan speed for high productivity
- Rendering Engine for Clean Page (ReCP) for sharp images



Print smarter and faster on the go with top wireless technologies

Samsung X3280 series offers smarter printing on the go:

- 7" capacitive touchscreen for intuitive, smartphone-like usability
- Active NFC for easy identification and print-on-tap via smartphone
- 802.11 b/g/n wireless option for high-speed mobile printing
- Convenient mobile printing without a printer driver using solutions such as Google Cloud Print, AirPrint, Mopria and Samsung Cloud Print™



Stay worry-free from failure, security risk and downtime

Samsung X3280 series offers hassle-free reliability to keep your business up and running with:

- Samsung SPDS app, providing easy on-site printer servicing by users or service engineers
- Industry-best monthly duty cycle of up to 80,000 pages
- Multilayered, enterprise-level print security, including HDD overwrite and data encryption

Feature	Description
Authentication	Supports authentication through 802.1x, Simple Mail Transfer Protocol (SMTP), Lightweight Direct Access Protocol (LDAP) and Kerberos technologies, along with network use authentication at the control panel
Access Control	Enables administrators to lock/disable the control panel and restrict direct printing, access to the address book and the USB port
Job Protection	Protects print jobs with secure print, encrypted scanning, digital signatures and job logs
Network Security / Protocols	Secures company network and protocols through protocol and port disablement, IP and MAC address filtering, Secure Sockets Layer (SSL), Transport Layer Security (TLS) and other network security technologies
Hard Disk Protection	Safeguards the hard disk with encryption and overwrite capabilities



Cut operational costs with shared options and parts

X3280 series offers several cost-saving features to help you stay on budget, including:

- High performance and quality of Samsung MultiXpress X4300 series but at a lower price point
- Shared X4300 series options and service parts, such as Inner Finisher, Punch Kit, Fax, Dual Cassette Feeder, Stand, Wireless/NFC, Developer Unit (Mono), Tray and Roller, etc.

* Inner Finisher is only available for K3300NR.

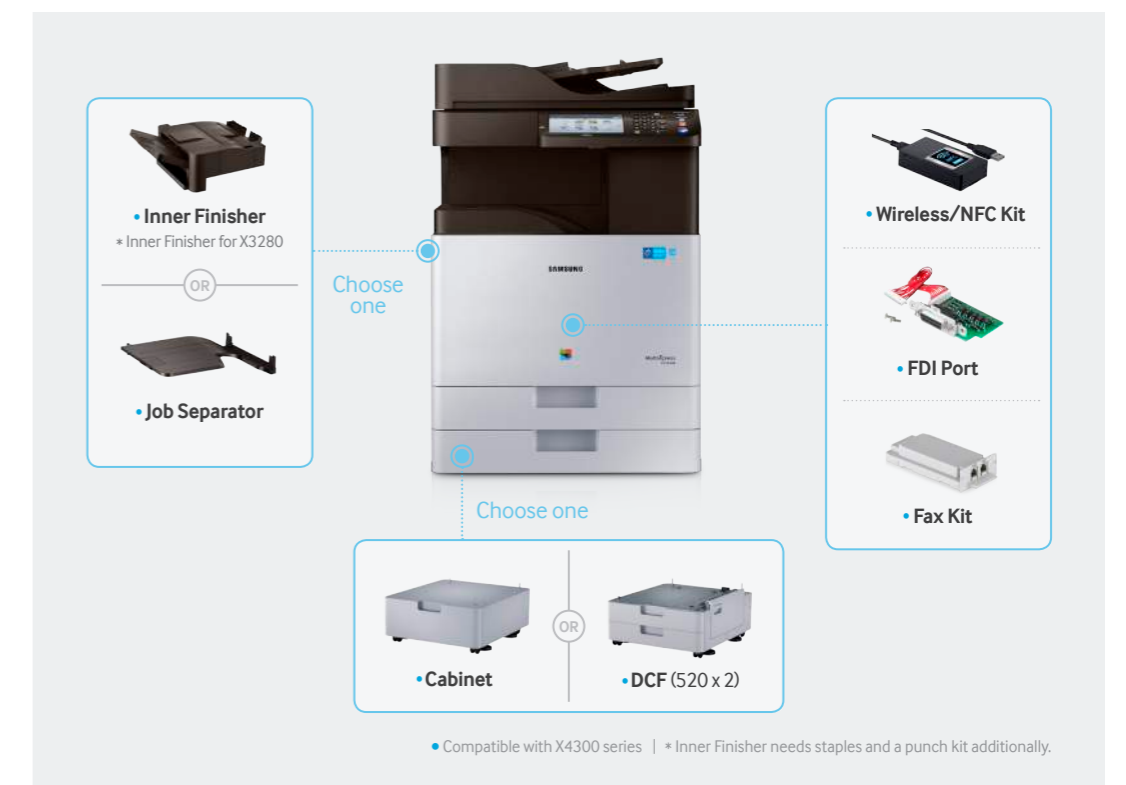

• Compatible with X4300 series | * Inner Finisher needs staples and a punch kit additionally.